

INSTALLATION INSTRUCTIONS

DESCRIPTION: GYTR Billet Ignition Cover
PART NUMBER: B4X-E54G0-V0
MODEL: 2005-2021+ YZ125
2020-2021+ YZ125X



⚠ WARNING

Please read and understand these instructions completely before installation to avoid possible injury, or damage to the accessory or vehicle.

IMPORTANT: YZ models are for closed-course competition only regardless of modification.

NOTICE:

Installation of this kit requires a torque wrench and should be performed by an authorized Yamaha dealer or a qualified mechanic.

WARRANTY INFORMATION:

In the United States, see your Yamaha dealer for a copy of the Yamaha Genuine Parts and Accessories Limited Warranty.

DEALER OR INSTALLER:

These instructions contain important information for future reference and *must* be given to the customer.

PARTS LIST:

No.	Part Number	Description	Qty
--	B4X-E54G0-V0	GYTR Billet Ignition Cover	--
①	*	Crankcase Cover	1
②	1C3-15451-00	Crankcase Cover Gasket	1
③	95022-06030	M6x1x30 Hex Head Flange Bolt	4

* Part supplied with kit only and not available separately.

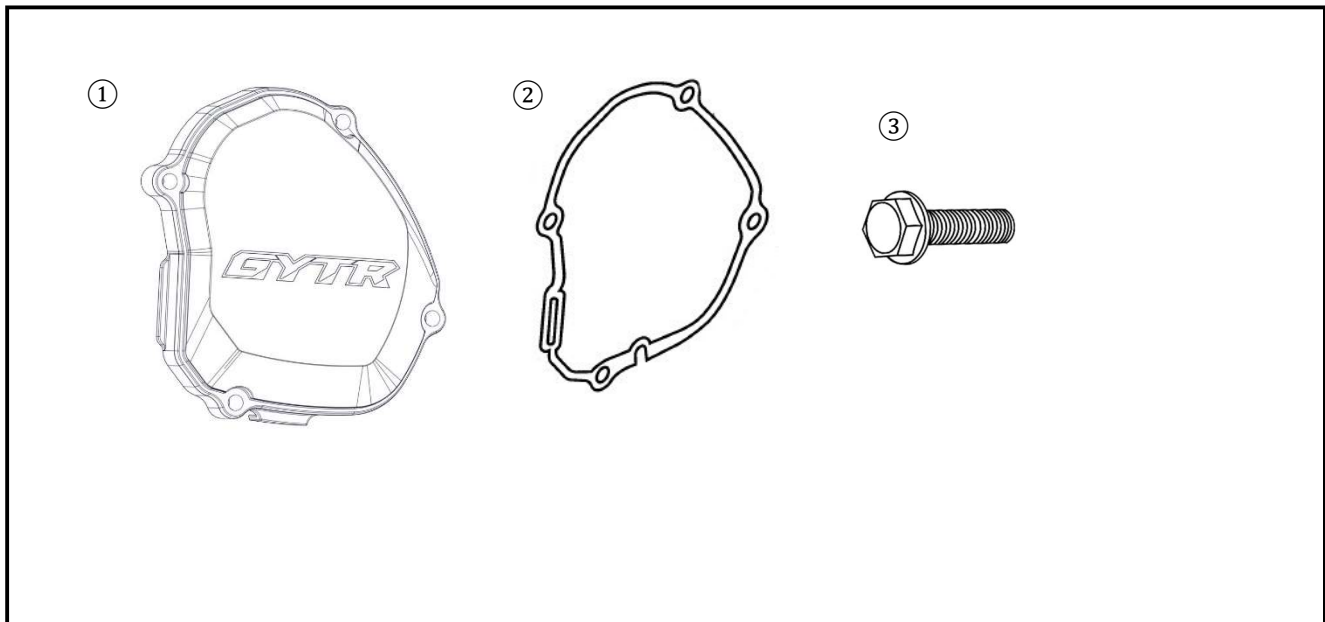

Fig. 1

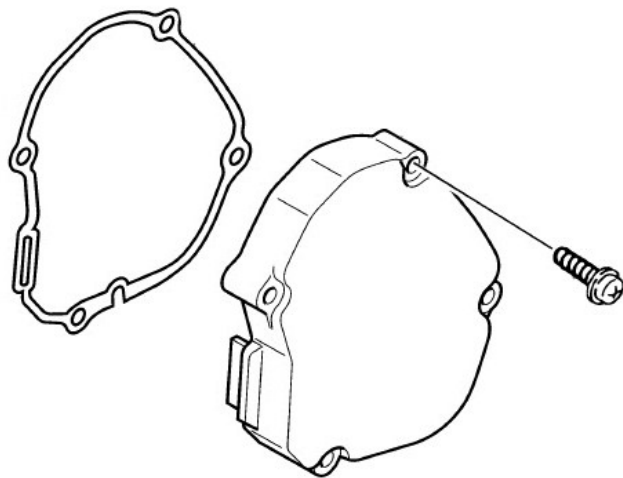

Fig. 2

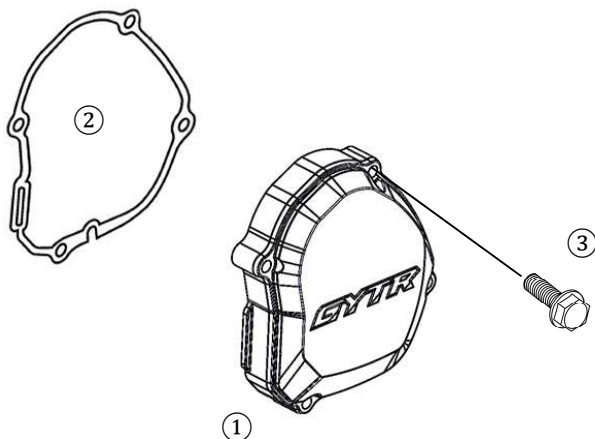
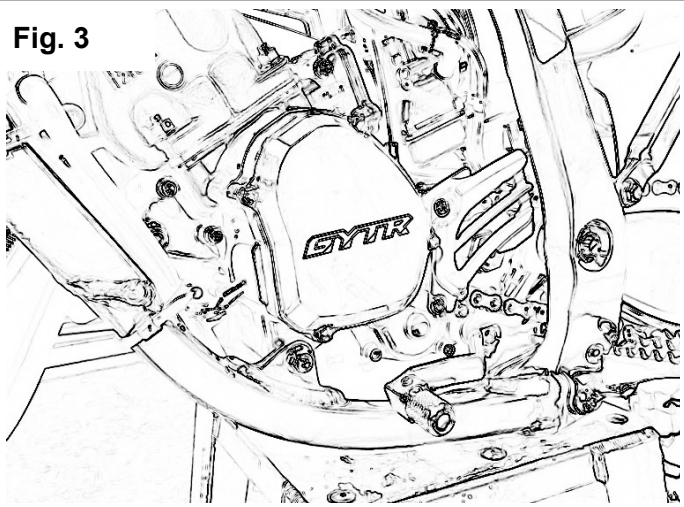

Fig. 3



PREPARATION:

- Place the motorcycle on a secure and level surface.
- Clean the mounting surfaces before beginning installation.

INSTALLATION:

1. Remove the stock ignition cover and gasket. The hardware is not reused. (Fig. 1)
2. Place the (2) Crankcase Cover Gasket on the (1) Crankcase Cover. (Fig. 2)
3. Place the new cover and gasket on the engine and align the bolt holes. (Fig. 2)
4. Thread in the (3) M6x1x30 Hex Head Flange Bolts through the cover and into the engine case. Torque to 5Nm (0.5 m-kg or 3.6 ft-lb). (Fig. 3)

MAINTENANCE:

Periodically, check torque on all hardware. If loose hardware is found, re-torque to specification.

CARE AND CLEANING:

Clean painted metal parts with a clean soft cloth and mild soap and water solution. Rinse and dry.

CUSTOMER SERVICE:

For further information see your Yamaha dealer.

ESTIMATED TIME TO INSTALL: 0.25 HRS.